

## N2 Standard

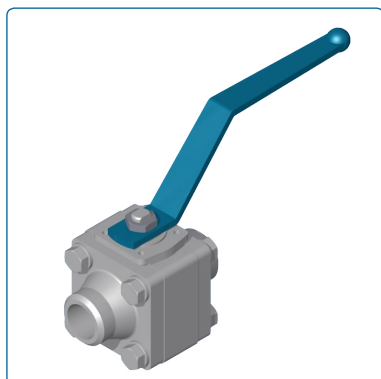

### 3-pcs. ball valve – steel / stainless steel

full / reduced bore, blow-out proof stem, soft sealing  
mounting flange in accordance with DIN ISO 5211, threaded ends or butt weld ends  
antistatic design  
manufactured in accordance with ASME B 16.34, ASME B 31.1, BS 5351

Approval / certification (partly for an additional charge):

3.1 B certificate in accordance with EN 10204

ATEX 94/9/EG, Ex IM2 / II 2GD

PED 97/23/EC, CE 97/23/CE Mod. H Kat. III

**N. diameter:** full bore: DN08 ... DN40; reduced bore: DN15 ... DN50  
**N. pressure:** PN16 ... PN100 (ANSI class 150 ... class 800)  
**Body:** steel: 1.0432 (ASTM A105); stainless steel: 1.4404 (ASTM A182 F316)  
**Ball:** stainless steel 1.4401 (AISI 316)  
**Gasket:** PTFE, more on request  
**Temperature:** -100 °C ... +260 °C  
**Face-to-face:** see table, special length on request  
**Optional:** actuator

### Order code

KH-N2- \_ \_ \_ \_ P \_  
N. diameter DN: \_ \_  
Steel: S  
Stainless steel: E  
Bore full: V  
Bore reduced: R  
Gasket PTFE: P  
Connection: \_

full bore		reduced bore		Face-to-face [mm]	Order code Steel	Order code Stainless steel
DN	Inch	DN	Inch			
08	1/4"	-	-	75	KH-N2-08S_P_	KH-N2-08E_P_
10	3/8"	15	1/2"	75	KH-N2-10S_P_	KH-N2-10E_P_
15	1/2"	20	3/4"	80	KH-N2-15S_P_	KH-N2-15E_P_
20	3/4"	25	1"	100	KH-N2-20S_P_	KH-N2-20E_P_
25	1"	32	1 1/4"	110	KH-N2-25S_P_	KH-N2-25E_P_
32	1 1/4"	40	1 1/2"	120	KH-N2-32S_P_	KH-N2-32E_P_
40	1 1/2"	50	2"	140	KH-N2-40S_P_	KH-N2-40E_P_

### Connection variants (more on request):

Female thread cylindrical	in accordance with DIN EN ISO 228-1	<b>D</b>
Female thread tapered	in accordance with ISO 7/1	<b>I</b>
Female thread NPT	in accordance with ANSI B1 20.1	<b>A</b>
Butt weld ends		<b>S</b>
Welding socket		<b>M</b>

## Type 300 F



### 2-pcs.-ball valve – stainless steel

full bore, stem stainless steel (1.4401), hand lever (steel / vinyl, red) lockable  
Female thread in accordance with ISO 7-1

**N. diameter:** DN8 ... DN80 (1/4" ... 3")  
**N. pressure:** 1000 psi / 69 bar  
**Body:** stainless steel ASTM A351 CF8M (1.4408)  
**Ball:** stainless steel ASTM A351 CF8M (1.4408)  
**Gasket:** PTFE  
**Temperature:** -18 °C ... +200 °C  
**Face-to-face:** see table

### Order code

KH-300F- \_ \_  
N. diameter DN: \_ \_

N. diameter DN	Inch	Face-to-face [mm]	Order code
08	1/4"	48,5	KH-300F-08
10	3/8"	48,5	KH-300F-10
15	1/2"	58,0	KH-300F-15
20	3/4"	65,0	KH-300F-20
25	1"	77,0	KH-300F-25
32	1 1/4"	90,0	KH-300F-32
40	1 1/2"	98,0	KH-300F-40
50	2"	120,0	KH-300F-50
65	2 1/2"	145,0	KH-300F-65
80	3"	161,5	KH-300F-80